

#10000

New Apartment For Sale In Moni Area

📍 Moni, Limassol

€277,000 +VAT



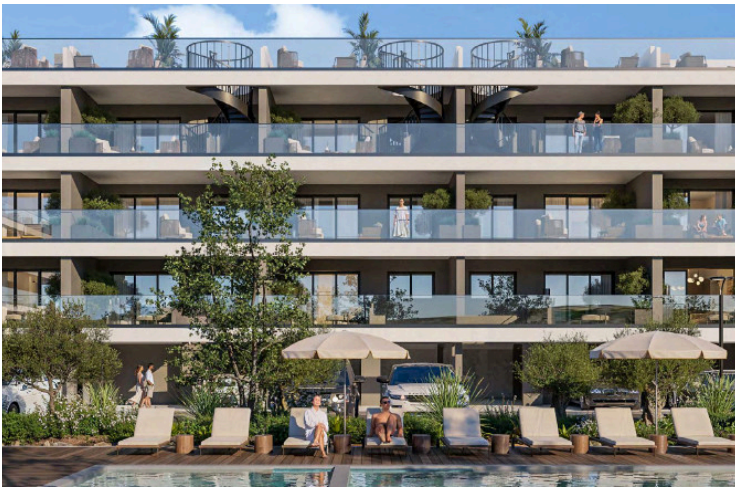
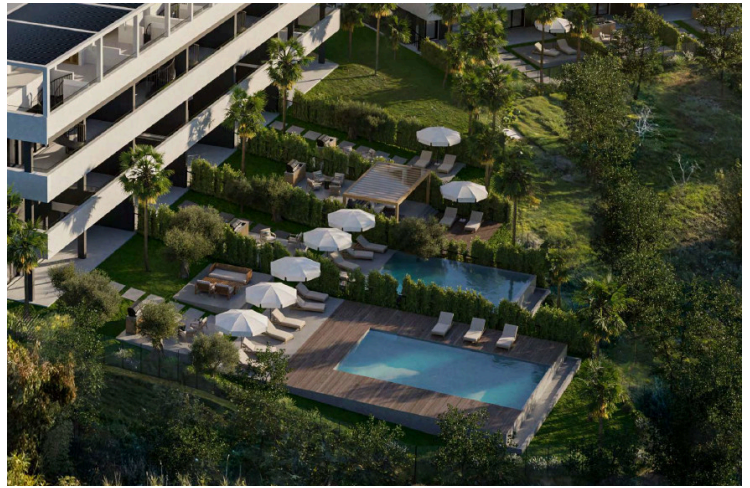

Overview

Specifications

Bedrooms



2

Bathrooms



2

Covered



78.98 m²

Type

Apartment

Status

Under construction

Covered veranda

12.64 m²

Energy efficiency rating



Description

The complex features three stylish buildings with cozy 1- and 2-bedroom apartments that can be easily combined into spacious bespoke residences. Inside, you will experience a boutique hotel vibe, complete with multiple swimming pools, private lounges, and perfect chill-out zones.

Exceptional infrastructure, featuring a common pool, kids pool, gym, sauna, bbq areas, extensive parking options and more.

*Location on map is indicative.



Floor plans



Additional information

Facilities

Aircondition, Split system

Childrens playground

Gated complex

Gym

Pool, Communal

Sauna

Features

Barbeque

CCTV

Double glazing

Easy access to highway

Contact us



Katerina Athini

✉ katerina@cyprusdomus.com

