

#10008

New Apartment For Sale In Moni Area

📍 Moni, Limassol

€294,000 +VAT



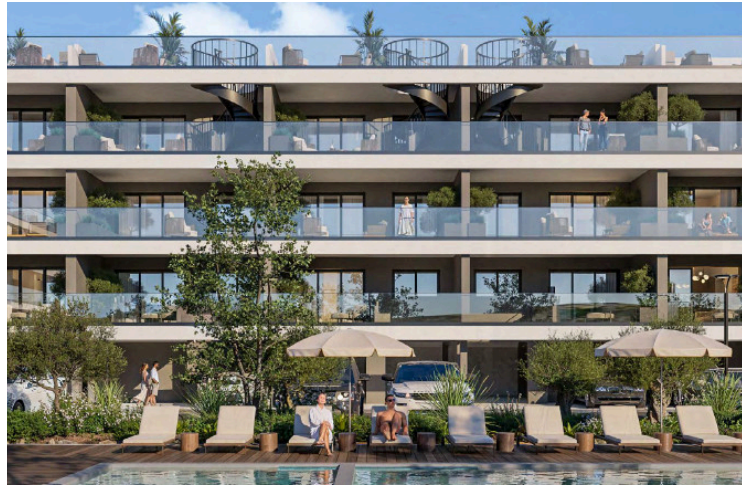

Overview

Specifications

Bedrooms



2

Bathrooms



2

Covered

82.13 m²

Type	Apartment	Status	Under construction
Covered veranda	14.95 m²	Energy efficiency rating	A
Uncovered veranda	15.09 m²		

Description

The complex features three stylish buildings with cozy 1- and 2-bedroom apartments that can be easily combined into spacious bespoke residences. Inside, you will experience a boutique hotel vibe, complete with multiple swimming pools, private lounges, and perfect chill-out zones.

Exceptional infrastructure, featuring a common pool, kids pool, gym, sauna, bbq areas, extensive parking options and more.

*Location on map is indicative.



Floor plans



Additional information

Facilities

Aircondition, Split system

Childrens playground

Gated complex

Gym

Pool, Communal

Sauna

Features

Barbeque

CCTV

Double glazing

Easy access to highway

Contact us



Katerina Athini

✉ katerina@cyprusdomus.com

