

#1570

# Ultra-Modern Design Offices In Limassol

 Petrou Kai Pavlou, Limassol

**€9,000** +VAT /month





# Overview

## Specifications

Covered

 302 m<sup>2</sup>

Type

**Office**

Status

**Under construction**

## Description

Ultra modern high quality office building located in a prime commercial area , near all amenities and with easy access to the highway.

The Project consists of a big basement (parking area), ground level with more covered parking area and an impressive lobby with reception area and 2 lifts, mezzanine with common kitchen area and mechanical area, 5 floors of spacious open plan offices with big covered verandas and a great roof garden with amazing sea and city views.

Prices From : €9.000 + VAT / month

# Floor plans

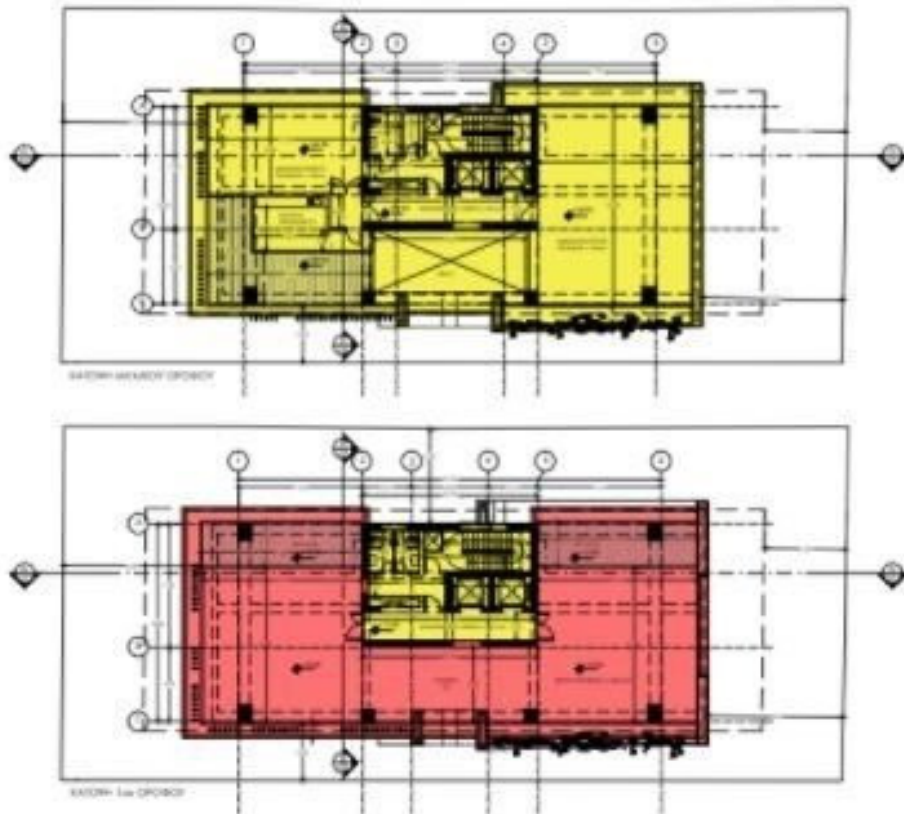

# Additional information

## Features

Reception

Roof garden

## Contact us



**Vassilis Papadopoulos**

☎ (+357) 99662023

✉ [info@cyprusdomus.com](mailto:info@cyprusdomus.com)