

#4472

New House for sale in Souni

 Souni, Limassol

€680,000 +VAT





Overview

Specifications

Bedrooms



4

Bathrooms



2

Covered

150 m²

Type	House
Toilets	1
Plot	765 m ²
Covered veranda	30 m ²

Covered parking	21 m ²
Status	Off plan
Energy efficiency rating	A

Description

This development is located in the elevated peaceful village of Souni in Limassol.

With the picturesque scenery of rolling hills and lush greenery, Souni offers a peaceful escape from the hustle and bustle of the city life.

The house consists of 3 bedrooms + 1 study room/bedroom, open plan kitchen dining and living area, 2 bathrooms (1 en-suite) and 1 guest w/c.

*Location on the map is indicative

Floor plans

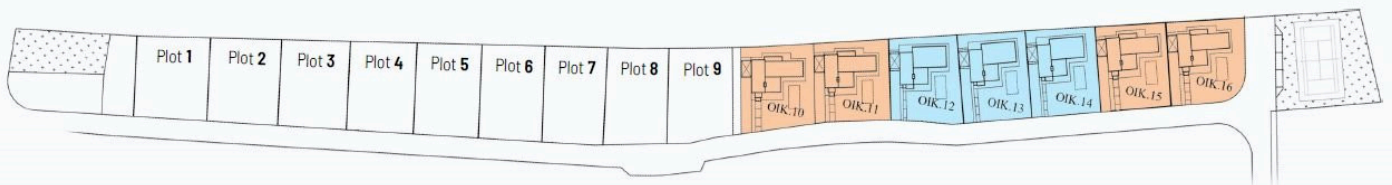

Additional information

Facilities

Aircondition, Provision

Childrens playground

Heating, Underfloor

Parking, Covered

Pool, Optional

Tennis court

Features

Country view

Laundry room

Study

Veranda

Contact us



Katerina Athini

✉ katerina@cyprusdomus.com