

#4736

# New Semi detached Houses for sale in Ypsonas area

 Ypsonas, Limassol

**€315,000** +VAT





# Overview

## Specifications

Bedrooms

 **3**

Bathrooms

 **2**

Covered

 **122 m<sup>2</sup>**

Type

**House**

Toilets

**1**

Plot

**135 m<sup>2</sup>**

Status

**Off plan**

## Description

This new project consists of 8, 3 bedroom houses in close proximity to all amenities.

This semi detached house consists of an open plan kitchen and dining area, separate living room, 3 bedrooms, 2 bathrooms (1 en suite) and 1 guest w/c.

\*Location on the map is indicative.

This architectural floor plan shows a building layout with various rooms and dimensions. The plan includes a central circular area labeled '5' with a radius of 1.10. To the left of this area is a room with a semi-circular protrusion, containing a toilet and a sink. To the right is a staircase with steps numbered 10 through 18. The plan also shows a large rectangular room at the bottom right, a smaller room at the bottom left, and a central corridor. Dimensions are provided for all major sections and individual rooms, including overall dimensions of 9.55 and 5.40 on the left, and 6.40 and 3.00 on the bottom. A specific elevation of +2.65 is marked near the bottom left corner.

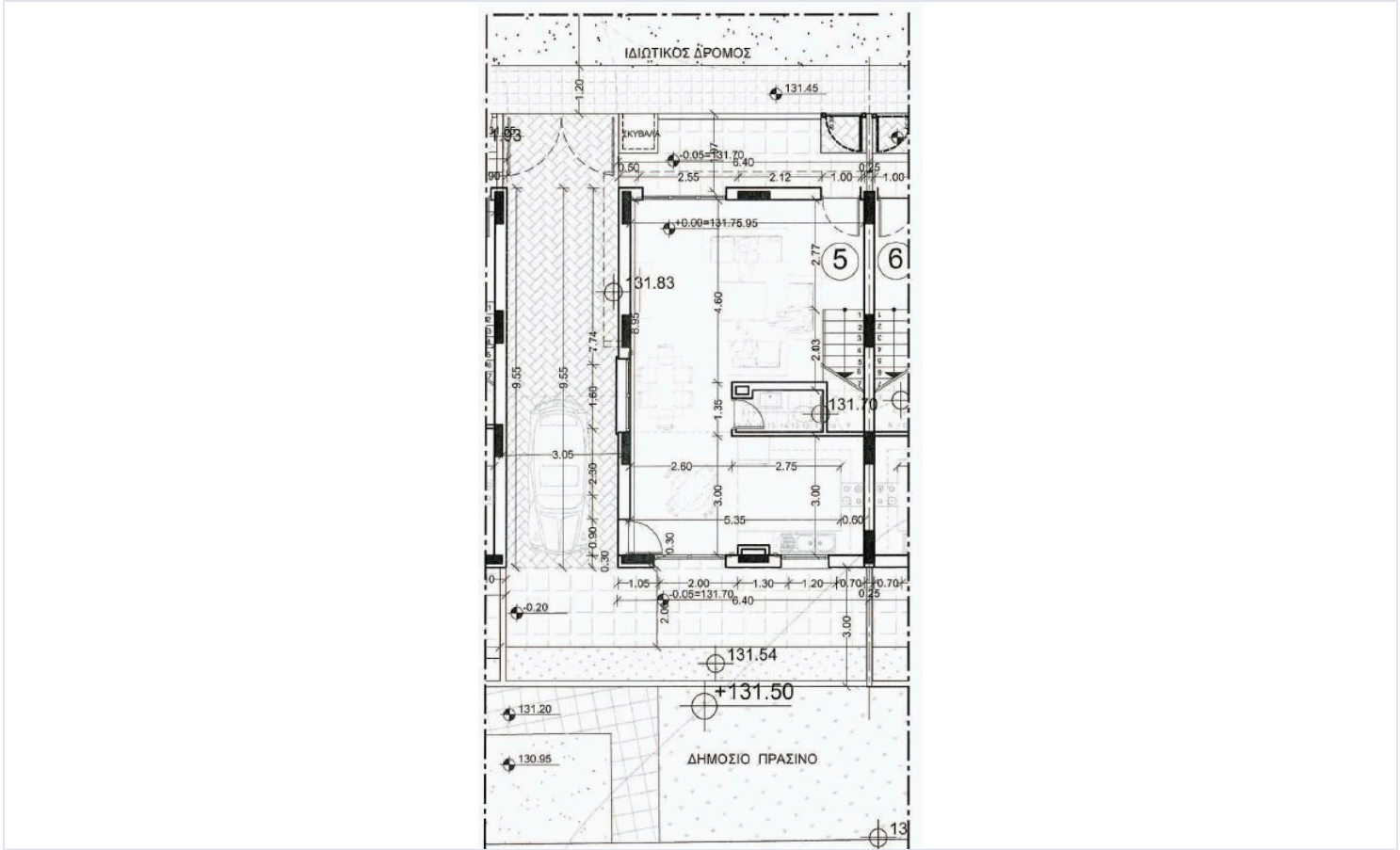

# | Additional information

## Contact us



**Katerina Athini**

✉ [katerina@cyprusdomus.com](mailto:katerina@cyprusdomus.com)