

#8097

Spacious 6 Bedroom Villa with Sea View with Swimming Pool For Sale in Paniotis Area

 Germasogeia, Limassol



€2,100,000





Overview

Specifications

Bedrooms		Bathrooms		Covered	
 6		 1		 414 m ²	
Type	House	Status	Resale		
Showers	4	Year of construction	2009		
Toilets	2	Title deed	Yes		
Plot	746 m ²	Furnished	Partially furnished		
Covered veranda	48.5 m ²	Structure	Concrete		
Uncovered veranda	46.5 m ²	Facade	Stone		

Description

With an internal space of 414 m², this elegant home is ideal for those seeking both luxury and comfort. Built in 2009 on a large plot, the property offers a welcoming environment with five bedrooms and a maid studio in the semi-basement (was full sunlight)

The well-designed living spacious areas are bright and airy, featuring a central VRV system on ground and first floors as also split units in semi-basement, central heating (diesel) for year-round comfort. Outside, you can relax or entertain by your own private swimming pool while taking in the panoramic views of the surrounding hills and coastline.

Germasogeia is known for its quiet, family-friendly atmosphere and quick access to schools, shops, and leisure facilities. The area combines scenic beauty with excellent amenities, making it a popular choice for those who value convenience and tranquility.

-Furniture are not included in the price

Panoramic Sea Views | Private Pool & Sauna | Gated | Cul-De-Sac

A timeless retreat in one of Limassol’s most elite locations — this luxury villa in Germasogeia Hills blends privacy, panoramic views, and refined elegance. Set in a quiet gated cul-de-sac of only 16 exclusive villas, the home offers elevated living just minutes from the city and coastline.



Floor plans

Semi-basement

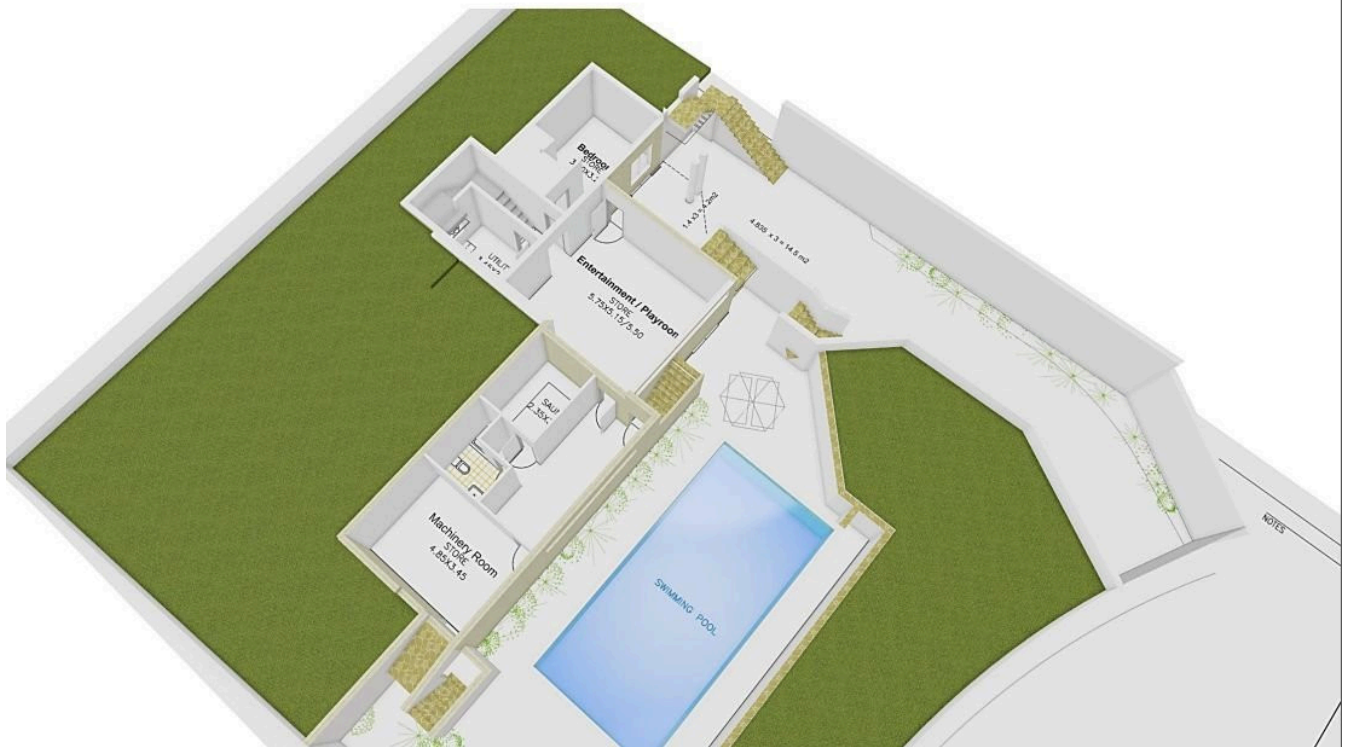

Ground Floor



Additional information

Facilities

Aircondition, Central system

Maid's room

Pool, Private

Childrens playground

Parking, Covered

Sauna

Heating, Central

Pergola

Storage

Features

Double glazing

High ceilings

Panoramic view

Garden

Indoor fireplace

Guest WC

Marble stairs

Distances

Amenities

 2.7 km

Airport

 63.1 km

Sea

 4.2 km

Schools

 5 km

Contact us



Andreas Chouloudes

 (+357) 94098260

 andreas@cyprusdomus.com

