

#8297

New Detached Houses in Parekkklisia

 Parekkklisia, Limassol

€440,000 +VAT





Overview

Specifications

Bedrooms



3

Bathrooms



2

Covered



194 m²

Type

House

Toilets

1

Plot

401 m²

Status

Off plan

Structure

Wood

Energy efficiency rating

 A

Description

This modern property features three bedrooms, two bathrooms, and 1 guest w/c, designed with functionality and style in mind. The open-plan living and dining areas provide a spacious atmosphere, perfect for family living and entertaining guests. Large windows bring in plenty of natural light, creating a bright and welcoming environment throughout the home.

Built with high-quality timber frame and designed to meet the highest standards, this home comes with energy efficiency class A, ensuring lower utility costs and a reduced environmental impact.

Situated in Parekklesia, this house enjoys a peaceful residential setting while remaining close to local amenities such as shops, schools, and dining options.

-Customizable layout & finishes

*Location on mpa is indicative.



Floor plans

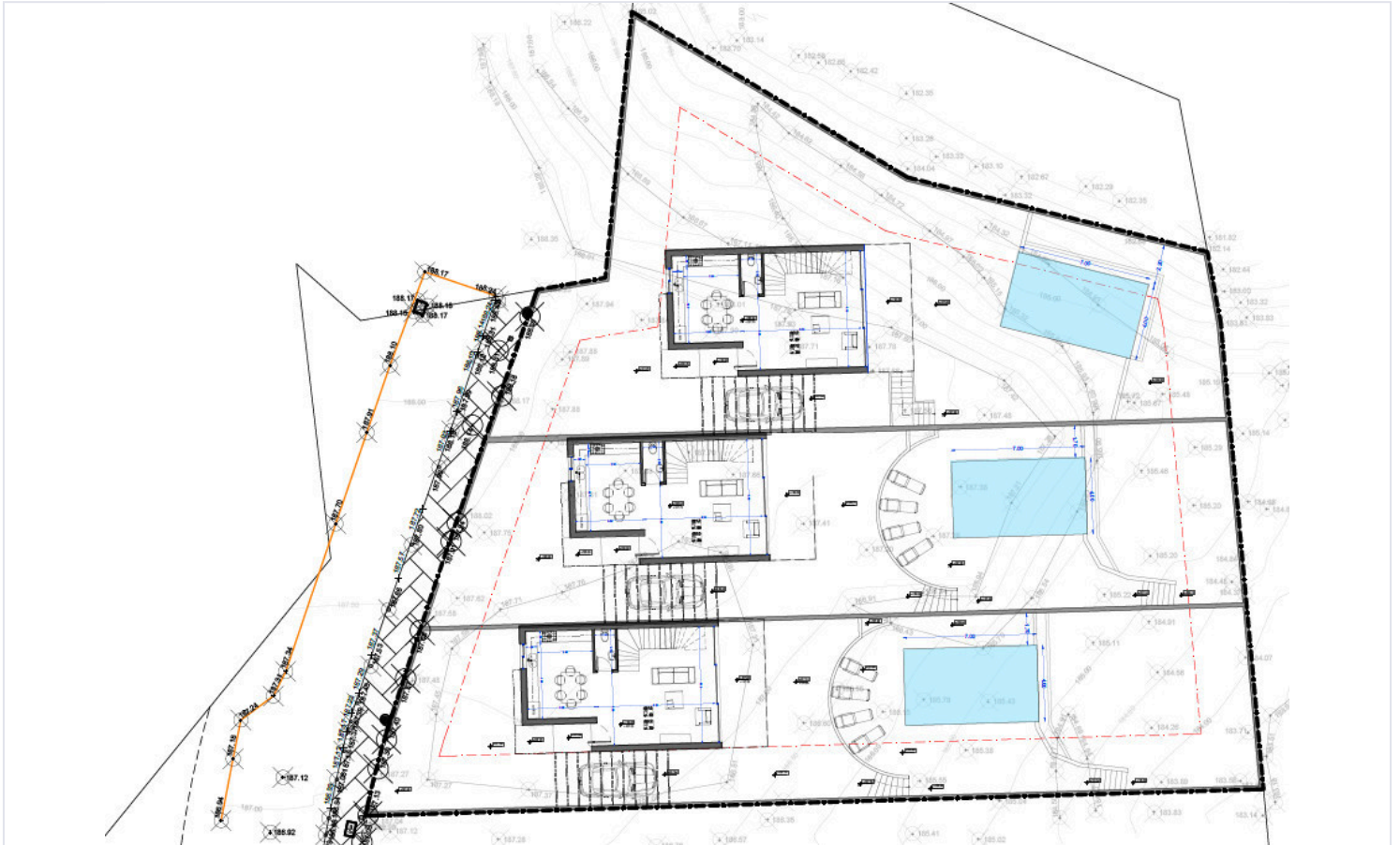

Additional information

Facilities

Aircondition, Split system

Solar photovoltaic panels

Features

Attic

Quiet area

Contact us



Katerina Athini

✉ katerina@cyprusdomus.com

